



Tom Parry

9, Garth Terrace, Porthmadog, LL49 9BE

£120,000

9 Garth Terrace, Porthmadog, LL49 9BE

An elevated property arranged over three floors with outstanding harbour and mountain views. 9 Garth Terrace is conveniently situated to access the High Street shops and the many leisure amenities that Porthmadog has to offer. There is a large utility room to the lower ground floor, kitchen and living room on the first floor, with second floor bedrooms and bathroom.

It is not every day that you find a property where every room offers wonderful views over the harbour and towards the Snowdon and Moelwynion mountain ranges.

Early viewing is recommended

Ref: P1273

ACCOMMODATION

Any measurements are approximate

LOWER GROUND FLOOR

Utility

with range of fitted wall and base units with modern high gloss doors and work surfaces over; stainless steel sink and drainer unit; space and plumbing for washing machine; built-in under stair storage; tile effect laminate flooring; night storage heater; door to rear

GROUND FLOOR

Hallway

with night storage heater; carpet flooring

Kitchen

with range of built-in wall and base units with modern high gloss doors and work surfaces over; space for gas double oven; 1 1/2 bowl stainless steel sink and drainer unit; space for fridge/freezer; stunning views across harbour and toward Moelwynion mountain range beyond

Living Room

with natural flame gas fire set in brick surround with timber mantle; carpet flooring; built-in storage; stunning views across harbour

SECOND FLOOR

Landing

with tall window to rear; ample built-in storage; carpet flooring

Bedroom 1

with outstanding harbour views; carpet flooring

Bedroom 2

with stunning views across harbour; built-in storage; carpet flooring

Bathroom

with shower cubicle with 'Mira Sport' electric shower fitted; low level WC; wash hand basin set in vanity unit; vinyl flooring; built-in airing cupboard housing water tank; night storage heater; heated towel rail

Services

All Mains Services





Tom Parry

01766 512505
tomparry.co.uk



THESE PARTICULARS ARE THOUGHT TO BE MATERIALLY CORRECT THOUGH THEIR ACCURACY IS NOT GUARANTEED AND THEY DO NOT FORM PART OF ANY CONTRACT.

working ability.

NOTE: The Agents have not tested any electrical installations, central heating system or other appliances and services referred to in these particulars and no warranty is given as to their

Floorplans are for identification purposes only and not to scale. Where measurements are shown, these are approximate and should not be relied on. Sanitary ware and kitchen fittings are representative only and approximate to actual shape, position and style. No liability is accepted in respect of any consequential loss arising from the use of this plan. Reproduced under licence from William Morris Energy Assessments. All rights reserved. Plan produced using PlanUp.



Ground Floor

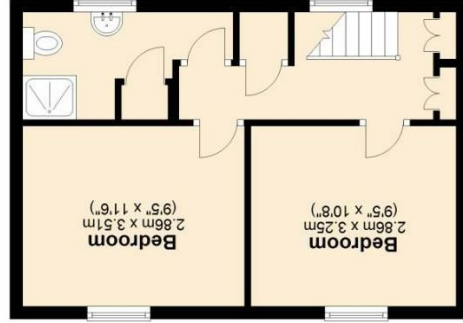

First Floor



Basement

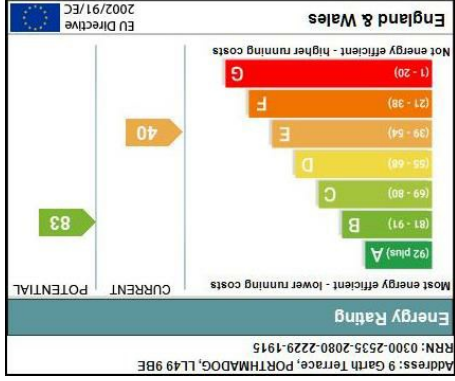

NOTE: The Agents have not tested any electrical installations, central heating system or other appliances and services referred to in these particulars and no warranty is given as to their